

LASVIT

H O M

E

D É

C

O

R

HOME & DÉCOR 2019 / 2020



Following the success of its Crystal Rock pendant lights, LASVIT has extended this versatile design line with its vases. Certainly not from the Stone Age, but closer to the fictional Kryptonite, Crystal Rock appears in the cave of the future as an ambassador to the fusion of nature and man, light and reflection, transparency and mass. All these characteristics are gathered within a contemporary silex that interacts between light and darkness.

Designed by Arik Levy

Crystal Rock Vase Small
CG017VA
Dimensions /
Dia 130 x H 175 mm
Dia 5 1/8" x H 6 7/8"
Weight / 1.1 kg / 2 7/16 lb
Packed Product Measurements /
165 x 230 x 160 mm
6 1/2" x 9 1/16" x 6 5/16"

Crystal Rock Vase Large
CG017VB
Dimensions /
Dia 216 x H 430 mm
Dia 8 1/2" x H 16 15/16"
Weight / 12 kg / 26 7/16 lb
Packed Product Measurements /
470 x 310 x 280 mm
18 1/2" x 12 3/16" x 11"

Color / Clear, Opal, Smoke, Light Amber,
Red, Blue, Uranium, Alexandrite

lasvit.com



CIRCLE

Circle Water
CG049GA
Dimensions /
Dia 70 x H 70 mm
Dia 2 3/4" x H 2 3/4"
Volume / 200 ml / 6,76 oz
Packed Product Measurements /
230 x 180 x 120 mm
Color / Clear

The fine collection of mouth-blown table glasses is composed of individual pieces, all hand crafted by traditional artisan glassmakers. The delicate linear engravings of the Circle crystal glasses result from the unique production process of each object in fine, pleated copper sheets. The flexible copper mould allows the fluid glass to form its distinct shape of free-flowing circles. Every piece is one of a kind. Enjoy and handle with care.

Designed by Milena Kling



YAKISUGI

Yakisugi Vase Small
CG035VA
Dimensions /
W 70 × H 300 × L 60 mm
W 2 3/8" × H 11 13/16" × L 2 3/4"
Weight / 1 kg / 2,2 lb
Packed Product Measurements /
290 × 140 × 140 mm
11 27/64" × 5 1/2" × 5 1/2"

Yakisugi Vase Large
CG035VB
Dimensions /
W 100 × H 250 × L 100 mm
W 3 15/16" × H 9 13/16"
× L 3 15/16"
Weight / 2,8 kg / 6,16 lb
Packed Product Measurements /
160 × 160 × 290 mm
6 19/64" × 6 19/64" × 11 27/64"

Yakisugi Vase Extra Large
CG035VC
Dimensions /
W 130 × H 440 × L 130 mm
W 5 1/8" × H 17 5/16" × L 5 1/8"
Weight / 6 kg / 13,2 lb
Packed Product Measurements /
490 × 190 × 190 mm
19 19/64" × 7 31/64" × 7 31/64"

Yakisugi Glass Water
CG035GA
Dimensions /
Dia 70 × H 90 mm
Dia 2 3/4" × H 3 9/16"
Volume / 200 ml / 6,76 oz
Packed Product Measurements /
230 × 180 × 120 mm
9 1/16" × 7 1/16" × 4 3/4"

Color / Clear

The renowned Japanese architect drew his inspiration from a technique for preserving construction timber by charring its surface, known in Japan as Shou-Sugi-Ban or Yakisugi. This ancient technique uses charring wood as a means to preserve it without the need of painting or sealing, an aspect leading to the current revival of this technique in eco-friendly architecture. Adapting this process to the centuries-old glass craft technique enabled a contemporary design that is unique for every single piece of hand-blown glass.

Designed by Kengo Kuma



The design for the Otto glassware collection was approached with a balance of refined detailing, applied to both the rustic qualities and the precise craftsmanship of each piece. Alternating radial and tangential cut lines provide dramatic texture to careful line work and the well-defined silhouettes of the Otto collection.

Otto Carafe
CG045RA
Dimensions /
Dia 134 x H 300 mm
Dia 5 1/4" x H 11 13/16"
Volume / 1700 ml / 57,48 oz
Weight / 1.5 kg / 3 5/16 lb
Packed Product Measurements /
350 x 160 x 150 mm
13 3/4" x 6 5/16" x 5 15/16"

Otto Decanter Long
CG045DA
Dimensions /
Dia 100 x H 300 mm
Dia 3 15/16" x H 11 13/16"
Volume / 1500 ml / 50,72 oz
Weight / 1.1 kg / 2 7/16 lb
Packed Product Measurement /
350 x 140 x 130 mm
11 13/16" x 11 5/8" x 12 13/16"

Otto Decanter Large
CG045DB
Dimensions /
Dia 200 x H 250 mm
Dia 7 7/8" x H 9 13/16"
Volume / 750 ml / 25,36 oz
Weight / 2 kg / 4 7/16 lb
Packed Product Measurement /
235 x 240 x 290 mm
13 3/4" x 5 1/2" x 5 1/8"

Otto Glass Highball
CG045GA
Dimensions /
Dia 75 x H 170 mm
Dia 2 15/16" x H 6 11/16"
Volume / 540 ml / 18,26 oz
Packed Product Measurements /
207 x 300 x 107 mm
8 1/8" x 11 13/16" x 4 3/16"

Otto Glass Champagne Coupe
CG045GB
Dimensions /
Dia 118 x H 130 mm
Dia 4 5/8" x H 5 1/8"
Volume / 250 ml / 8,54 oz
Packed Product Measurements /
233 x 350 x 120 mm
9 3/16" x 13 3/4" x 4 3/4"

Otto Glass Champagne Flute
CG045GC
Dimensions /
Dia 50 x H 216 mm
Dia 1 15/16" x H 8 1/2"
Volume / 170 ml / 5,75 oz
Packed Product Measurements /
207 x 300 x 107 mm
8 1/8" x 11 13/16" x 4 3/16"

Otto Glass Red Wine
CG045GD
Dimensions /
Dia 89 x H 150 mm
Dia 3 1/2" x H 5 7/8"
Volume / 260 ml / 8,79 oz
Packed Product Measurements /
207 x 300 x 107 mm
8 1/8" x 11 13/16" x 4 3/16"

Otto Glass Water
CG045GE
Dimensions /
Dia 76 x 70 mm
Dia 3" x H 2 3/4"
Volume / 160 ml / 5,41 oz
Packed Product Measurements /
211 x 245 x 107 mm
8 5/16" x 9 5/8" x 4 3/16"

Otto Glass Tumbler
CG045GF
Dimensions /
Dia 60 x H 140 mm
Dia 2 3/8" x H 5 1/2"
Volume / 260 ml / 8,79 oz
Packed Product Measurements /
211 x 245 x 107 mm
8 5/16" x 9 5/8" x 4 3/16"

Otto Glass White Wine
CG045GG
Dimensions /
Dia 68 x H 170 mm
Dia 2 11/16" x H 6 11/16"
Volume / 210 ml / 7,10 oz
Packed Product Measurements /
207 x 300 x 107 mm
8 1/8" x 11 13/16" x 4 3/16"

Otto Cooler
CG045CA
Dimensions /
Dia 240 x H 280 mm
Dia 9 7/16" x H 11"
Weight / 10 kg / 22 1/16 lb
Packed Product Measurements /
300 x 295 x 325 mm
11 13/16" x 11 5/8" x 12 13/16"

Otto Vase Botanical
CG045VA
Dimensions /
Dia 198 x H 330 mm
Dia 7 13/16" x H 13"
Weight / 4,5 kg / 9 15/16 lb
Packed Product Measurements /
255 x 255 x 360 mm
10 1/16" x 10 1/16" x 14 3/16"

Otto Vase Rotund
CG045VB
Dimensions /
Dia 340 x H 115 mm
Dia 13 3/8" x H 4 1/2"
Weight / 5 kg / 11 lb
Packed Product Measurements /
390 x 390 x 150 mm
15 3/8" x 15 3/8" x 5 15/16"

Otto Vase Cylinder
CG045VC
Dimensions /
Dia 225 x H 225 mm
Dia 8 7/8" x H 8 7/8"
Weight / 5 kg / 11 lb
Packed Product Measurements /
280 x 280 x 265 mm
11" x 11" x 10 7/16"
Color / Clear



BORN BROKEN

Born Broken Vase Large
CG040VB
Dimensions /
Dia 130 x H 375 mm
Dia 5 1/8" x H 14 3/4"
Weight / 4.8 kg / 10 9/16 lb
Packed Product Measurements /
440 x 180 x 180 mm
17 5/16" x 7 1/16" x 7 1/16"

Born Broken Vase Small
CG040VA
Dimensions /
Dia 90 x H 330 mm
Dia 3 9/16" x H 13"
Weight / 3 kg / 6 5/8 lb
Packed Product Measurements /
160 x 410 x 155 mm
6 5/16" x 16 1/8" x 6 1/8"

Color / Clear

Inspired by the craft itself, these vases remind us of the otherwise unseen aspects of glass production — its production errors. Each hand-blown shape is broken into several segments and their edges additionally hammered to create a pattern visually similar to cutting. The individual pieces are reheated and joined into one unit, creating a safe and compact surface, but retaining their intriguing random patterns.

Designed by Jakub Berdych



Candy Glass Tumbler / CG013GA
 Dimensions / Dia 90 x H 150 mm
 Dia 3 9/16" x H 5 7/8"
 Volume / 330 ml / 11,6 oz
 Packed Product Measurements /
 145 x 245 x 200 mm
 5 11/16" x 9 5/8" x 7 7/8"

Candy Glass Whiskey / CG013GB
 Dimensions / Dia 90 x H 84 mm
 Dia 3 9/16" x H 3 5/16"
 Volume / 150 ml / 5,07 oz
 Packed Product Measurements /
 145 x 245 x 130 mm
 5 11/16" x 9 5/8" x 5 1/8"

Candy Carafe Base Size / CG013RA
 Dimensions / Dia 130 x H 290 mm
 Dia 5 1/8" x H 11 7/16"
 Volume / 1500 ml / 50,72 oz
 Weight / 2 kg / 4 7/16 lb
 Packed Product Measurements /
 240 x 320 x 200 mm
 9 7/16" x 12 5/8" x 7 7/8"

Candy Vase Long / CG013VA
 Dimensions / Dia 123 x H 470 mm
 Dia 4 13/16" x H 18 1/2"
 Weight / 3 kg / 6 5/8 lb
 Packed Product Measurements /
 195 x 550 x 190 mm
 7 11/16" x 21 5/8" x 7 1/2"

Candy Vase Large / CG013VB
 Dimensions / Dia 160 x H 360 mm
 Dia 6 5/16" x H 14 3/16"
 Weight / 3,7 kg / 8 3/16 lb
 Packed Product Measurements /
 220 x 440 x 215 mm
 8 11/16" x 17 5/16" x 8 7/16"

Candy Cheese Lid / CG013EA
 Dimensions / Dia 320 x H 223 mm
 Dia 12 5/8" x H 8 3/4"
 Weight / 2,4 kg / 5 5/16 lb
 Packed Product Measurements /
 395 x 385 x 300 mm
 15 9/16" x 15 3/16" x 11 13/16"

Color / By Design (Colored)



CANDY

The Candy tableware now complements existing lighting sculptures, and the Candy collection builds on the colorful universe explored and expressed through glass. The collection is inspired by colorful candies, and the brightness of the glass combined with the palette of colors and the visual aspect of the colorful lines make you imagine the piece as a delicious candy. Lollipop!



COOLER



Cooler
CG039CA
Dimensions /
Dia 220 x L 390 x H 260 mm
Dia 8 11/16" x L 15 3/8" x H 10 1/4"
Weight / 8.5 kg / 18 3/4 lb
Packed Product Measurements /
285 x 475 x 320 mm
11 1/4" x 18 11/16" x 12 5/8"
Color / Clear, Uranium, Alexandrite

“The priority is elegance,” said Jan Kaplický, maintaining that he sees design merely as small elements of architecture. This champagne bucket carries his classic elegance, organic curves as well as a hint of his futuristic tendencies. Executed with a world-class level of craftsmanship, the piece pays homage to one of the greatest visionaries of architecture of the 20th century.

Designed by Jan Kaplický



FROZEN

Frozen Bowl Baby
CG014BA
Dimensions /
Dia 210 x H 150 mm
Dia 8 1/4" x H 5 7/8"
Weight / 2.3 kg / 5 1/16 lb
Packed Product Measurements /
280 x 280 x 210 mm
11" x 11" x 8 1/4"

Frozen Bowl Small
CG014BB
Dimensions /
Dia 360 x H 170 mm
Dia 14 3/16" x H 6 11/16"
Weight / 7.3 kg / 16 1/16 lb
Packed Product Measurements /
445 x 435 x 255 mm
17 1/2" x 17 1/8" x 10 1/16"

Frozen Bowl Large
CG014BC
Dimensions /
Dia 480 x H 150 mm
Dia 18 7/8" x H 5 7/8"
Weight / 13 kg / 28 11/16 lb
Packed Product Measurements /
565 x 555 x 270 mm
22 1/4" x 21 7/8" x 10 5/8"

Color / Clear, Smoke, Light Amber,
Uranium

Frozen Cooler
CG014CA
Dimensions /
Dia 300 x H 350 mm
Dia 11 13/16" x H 13 3/4"
Weight / 10 kg / 22 1/16 lb
Packed Product Measurements /
400 x 400 x 500 mm
15 3/4" x 15 3/4" x 19 11/16"

Color / Clear, Uranium

The Frozen collection was inspired by the transformation of water into ice, the element of randomness used in the context of glassmaking. Glassmakers understand that their material always ‘freezes’ at some moment in the process and only the most skilled hands are capable of creating a unique form. Each piece traces a unique record of the process, becoming an original all of its own.



When making the Papilla vases, it was first and foremost the beauty of the glass itself which guided the hand of artist Vladislav Urban. The initial design was made by a Czech artist during the golden era of metallurgical glass in the 1960s. The vases received the name Papilla due to their round protrusions which are reminiscent of nipples, or papillae in Latin.

Designed by Vladislav Urban

Papilla Vase Small
CG079VA
Dia 120 x L 173 mm
Dia 4 3/4" x L 6 13/16"
Packed Product Measurements /
120 x 130 x 230 mm
4 3/4" x 5 1/8" x 9 1/16"

Papilla Vase Large
CG079VB
Dia 160 x L 230 mm
Dia 6 5/16" x L 9 1/16"
Packed Product Measurements /
150 x 170 x 290 mm
5 7/8" x 6 11/16" x 11 7/16"

Color / By Design (Colored)



Chřibská 1414 Vase A
CG090VA
Dia 110 x L 660 mm
Dia 4 5/16" x L 26"
Packed Product Measurements /
740 x 160 x 160 mm
29 1/8" x 6 5/16" x 6 5/16"
Color / Blue

Chřibská 1414 Vase B
CG090VB
Dia 190 x L 400 mm
Dia 7 1/2" x L 15 3/4"
Packed Product Measurements /
490 x 230 x 230 mm
19 5/16" x 9 1/16" x 9 1/16"
Color / Red

Chřibská 1414 Vase C
CG090VC
Dia 100 x L 400 mm
Dia 3 15/16" x L 15 3/4"
Packed Product Measurements /
490 x 140 x 130 mm
9 5/16" x 5 1/2" x 5 1/4"
Color / Japanese Topaz

Chřibská 1414 Vase D
CG090VD
Dia 160 x L 500 mm
Dia 6 5/16" x L 19 11/16"
Packed Product Measurements /
590 x H 200 x L 200 mm
23 5/16" x 7 7/8" x 7 7/8"
Color / Olive

The unique edition of vases called "Chřibská 1414" carries on the 600-year legacy of Chřibská glassworks near Nový Bor. LASVIT fashioned the four distinctly colored vases made from industrial glass according to the original design of artist Josef Hospodka, who created them in the 1950s.

Designed by Josef Hospodka

Lasvit is a creative hub of glassmaking talents, fresh ideas, and daring designs. This young, progressive Czech glassmaking and design company inspires the world with its breathtaking custom-made installations exhibited all over the world, as well as with their unique lighting and glassware collections made from hand-blown glass. This original approach captivated design professionals and made Lasvit an award-winning company. In 2018 Lasvit won the design “Oscar” at Salone del Mobile.

The founder of Lasvit, Leon Jakimič, steers the company with the utmost respect for the Czech glassmaking tradition, but also with a boundless optimism for modern technologies and cutting-edge design.

In past years, Lasvit has attracted many renowned designers and artists who wanted to collaborate with an unconventional Czech company. In cooperation with Lasvit, many stars such as the Campana Brothers, Kengo Kuma, Yabu Pushelberg, Nendo or Ross Lovegrove, have created some of their most unforgettable glass collections. Ever since 2007, Lasvit has been on a mission: to bring beauty, happiness, and a piece of the Bohemian soul to clients worldwide, and thus change the world for the better. Let Lasvit in, let the changes begin.

#LasvitDesign #LasvitCollections



Bespoke installations

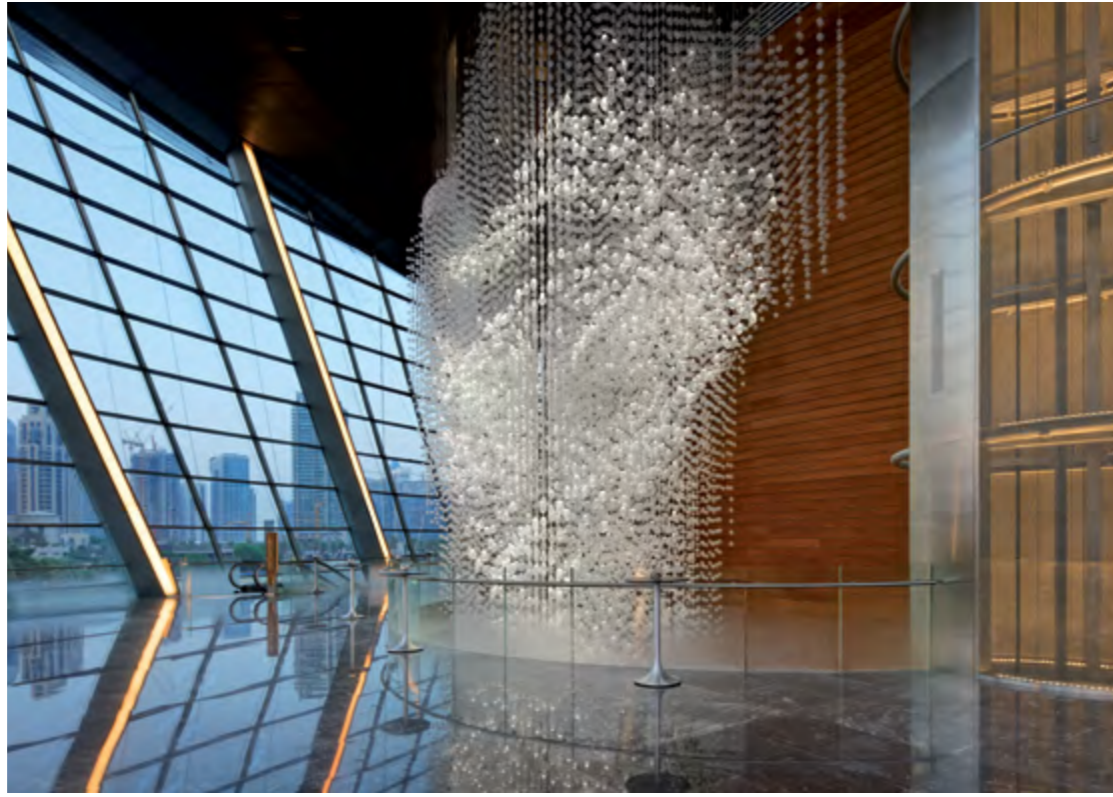

Dubai Opera

Glass for architecture



Lasvit Liquidkristal

OUR CENTERS OF INNOVATION



SLS LUX Brickel / Miami

The Beauty of Glass



Four Seasons / Kuwait

Collections of lighting, home & décor and monsters

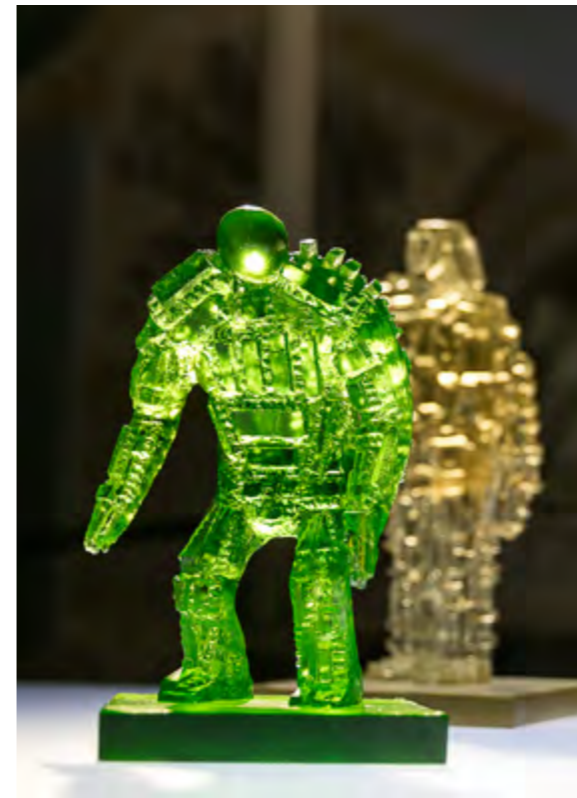

Monster Collection / Outer Space Monster by Campana Brothers



Lighting Collection / Neverending Glory by Jan Plecháš & Henry Wielgus

lasvit.com

Home & Décor

Headquarters
Nový Bor
 nám. Míru 55
 473 01 Nový Bor
 Czech Republic
 T +420 481 120 810
 F +420 481 120 622
 E lasvit@lasvit.com

Flagship Showroom
Prague
 Lasvit s.r.o.
 Komunardů 32
 170 00 Prague
 Czech Republic
 T +420 222 362 990
 E lasvit@lasvit.com

USA Headquarters
Showroom New York
 Lasvit Inc. / New York
 51 Wooster Street
 New York
 NY 10013, USA
 T +1 212 219 3043
 F +1 212 219 3053
 E america@lasvit.com

Dubai
 LASVIT Middle East FZ-LLC
 PO Box 333272
 Dubai Design District
 A 109, Building 6
 Dubai, UAE
 T +971 4453 8689
 F +971 4453 8784
 E me@lasvit.com

Hong Kong
 Lasvit (H.K.) Limited
 8F / The Hennessy
 256 Hennessy Road
 Wan Chai / Hong Kong
 S.A.R.
 T +852 2866 1234
 F +852 2866 2212
 E asia@lasvit.com

Shanghai
 Lasvit Shanghai Co., Ltd.
 Room 237 2F
 No. 315 Yuyuan Rd.
 Shanghai 200040, China
 M +86 182 1709 0498
 E shanghai@lasvit.com

Singapore
 Lasvit (Singapore) Pte. Ltd.
 75 Neil Road
 Singapore 088902
 T +65 6542 9422
 E singapore@lasvit.com

Paris
 Lasvit (FR)
 T +33 (0) 7 50 90 78 04
 E france@lasvit.com

London
 Lasvit UK Ltd.
 3rd Floor
 131 Shoreditch High Street
 London, E1 6JE
 United Kingdom
 T +44 20 7490 2004
 E uk@lasvit.com

Moscow
 Lasvit (Russia & CIS)
 Bryusov pereulok 2/14
 building 9
 Moscow 125009
 Russian Federation
 T +7 985 6450920
 E russia@lasvit.com

Astana
 Lasvit (Kazakhstan)
 Kunaev Street 12/1
 office 115
 Astana 010000
 T +7 776 774 9669
 E kazakhstan@lasvit.com

lasvit.com

The visualization of the products in this catalogue is solely illustrative. Due to the manufacturing process by hand, the factual appearance of the products and their parameters may significantly differ from the visual information in this book.

